



Nothing else measures up!

Follow us!



Prospect House
George Cayley Drive
Clifton Moor
York
England
YO30 4XE

Tel: +44 (0) 1904 692723
Fax: +44 (0) 1904 690385

E-Mail: sales@yorksurvey.co.uk



3.8m Xtend+Climb Telescoping Pro Ladder



Operating Instructions

OPERATIONAL AND SAFETY INSTRUCTIONS

DANGER: FAILURE TO UNDERSTAND AND FOLLOW ALL SAFETY RULES AND OPERATIONAL INSTRUCTIONS COULD RESULT IN SERIOUS INJURY OR DEATH



WARNING: ELECTRICITY HAZARD: Identify any electrical risks in the work area, such as overhead lines or other exposed electrical equipment and do not use the ladder where electrical risks occur.



COMPONENTS OF A TELESCOPIC LADDER

ENGLISH

Top Section - Upper horizontal section of the ladder.

Top Cap - Top section of the ladder that encloses the upper stile.

Lock Indicator - Green/Red indicator that alerts the user when the section is locked or unlocked.

Rung - Horizontal section used for climbing the ladder.

Stile - Vertical member used to support the rungs and the ladder structure.

Coupling - The section that connects the rung to the stile of the ladder.

Grip Handle - Ergonomic pad on the bottom of the second rung from the bottom that the user uses to comfortably transport the ladder.

Release Latch - Mechanical button or switch that allows the user to unlock the section at the bottom to start the closing process.

Securing Strap - Nylon strap with hook and loop fasteners, which holds the ladder together during transportation and storage.

Stabiliser/Bottom Foot - Ladder base with anti-slip design that supports the ladder during use.

Bottom Rung - Lower horizontal section used for climbing the ladder.

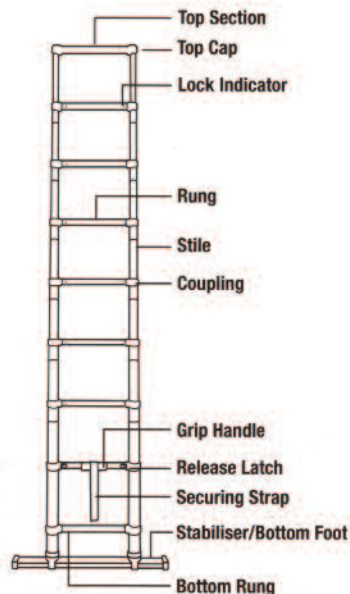

Customer Service Telephone number: 029 2132 0000

Our customer service staff are available to help you. For any help with the product, to report damaged or missing parts, or for any other information about this product, please call.

KEEP THIS MANUAL FOR FUTURE REFERENCE

Keep this manual and the original sales invoice in a safe, dry place for future reference.

Limited Warranty

Xtend+Climb® is a brand of Core Distribution, Inc.

Core Distribution, Inc. has a limited lifetime warranty. Core Distribution, Inc. will replace any Xtend+Climb® ladder should it fail due to defects in material or workmanship, under normal conditions and use to the original owner of the Xtend+Climb® ladder.

The Limited Lifetime Warranty is conditioned upon the ladder being operated under normal conditions and use, and properly maintained in accordance with the owner's handbook (as supplied with the Xtend+Climb® ladder). Xtend+Climb® ladders are tested to withstand normal wear and tear, but are not indestructible and can be damaged by misuse and neglect. Our warranty, just like other warranties worldwide, will not cover wear and tear, misuse, and/or abusive treatment.

Additional Conditions: This Limited Lifetime Warranty is made solely to the original owner of this new Xtend+Climb® ladder, and shall remain in force only as long as the original owner retains ownership of the ladder. This Limited Lifetime Warranty is not transferable.

In order to exercise your rights under this Limited Lifetime Warranty, the ladder must be presented to Xtend+Climb® or an authorised dealer, together with appropriate written proof of purchase, which identifies the ladders batch number.

EXCLUSIONS & LIMITATIONS:

The warranty DOES NOT cover:

- Modifications from the original condition.
- Normal wear and tear.
- Use of the ladder for abnormal activities, or for purposes other than those for which the ladder was designed.
- Damage caused by failure to follow the instruction manual.
- Neglect and failure to care for the product.
- Surface finish and decal damage resulting from normal wear and tear.
- Labour and/or transport charges for full or part replacement, repair, return, or changeover.
- Accident, neglect, improper handling, abuse or wilful damage, misuse and improper use.
- Any alteration or repair by you or a third party who is not one of our authorised repairers.

This shall be in lieu of any other warranty, expressed or implied, including, but not limited to, any implied warranty of merchantability or suitable for a particular purpose. The liability of Core Distribution, Inc. under this warranty shall be limited solely to repair or replacement of the ladder within the warranty period; and Core Distribution, Inc. shall not be liable, under any circumstances, for consequential or incidental damages, including but not limited to, personal injury or labour costs.

In the event of any defect, this product will be repaired or replaced at TB Davies (Cardiff) Ltd.'s option without charge. The obligation to repair or replace this product at TB Davies, Ltd.'s option shall be the company's only obligation with respect to defects in this product. This product must be returned, PREPAID, together with sales slip or other proof of purchase.

For return authorisation and shipping information, contact TB Davies (Cardiff) Ltd. Lewis Road, Cardiff CF24 5EB, UK Telephone: 029 2132 0000. Prior authorisation from TB Davies (Cardiff) Ltd. is required for all returns.

Manufacturing specifications are subject to change without notice.

ENGLISH

LADDER INSPECTION



WARNING: BEFORE USE, A THOROUGH INSPECTION OF THE LADDER MUST BE MADE. IF ANY OF THE CHECKS CANNOT BE FULLY SATISFIED, DO NOT USE THE LADDER.

- Check that the stiles/legs (uprights) are not bent, bowed, twisted, dented, cracked, or corroded.
- Check that the stiles/legs around the coupling, fixing point, are not dented cracked or corroded.
- Check that hardware (rivets, screws or bolts) are not missing, loose, or corroded.
- Check that rungs/steps are not missing, loose, excessively worn, corroded or damaged.
- Check that the stabilisers are not damaged, loose or corroded.
- Check that the locking mechanisms are not missing, damaged, loose or corroded and engage properly.
- Check that guide brackets are not missing, damaged, loose or corroded and engage properly on the mating stile.
- Check that ladder feet are not missing, loose, excessively worn, corroded or damaged.
- Check that the entire ladder is free from contaminants (e.g. dirt, mud, paint, oil or grease.)
- Check that the locking mechanisms for the stabiliser are not damaged or corroded and function and lock correctly.
- Check that the platform (if fitted) has no missing parts or fixings and is not damaged or corroded.

Repairs and maintenance shall be carried out by a competent person.

NOTE: A competent person is someone who has the skills to carry out repairs or maintenance, e.g. by training by the manufacturer or authorised distributor.

For repair and replacement of parts, e.g. feet, if necessary contact the authorised distributor.

ENGLISH

OPERATIONAL AND SAFETY INSTRUCTIONS

EXTENDING THE LADDER (PARTIALLY)

Place the ladder on a sturdy level surface suitable on which to use a ladder. Release the strap that secures the ladder in its "storage configuration." Extend the telescopic stabiliser from one side of the ladder. Ensure the stabiliser is fully extended by confirming you can visually see the green indicator. Repeat with the other side. Place your foot on the bottom rung to hold the ladder in place. With both hands start to pull up on the rung that you determine will be the highest point to which you would like to extend the ladder. Extend each section until the steel locking pin engages. You will hear an audible click and see a green indicator on the rung below confirming that section is fully extended and locked. Continue extending the ladder all the way up. Once fully extended, each section should show a green lock indicator. Visually inspect the ladder for any damage, debris and ensure that all open sections are locked.



ENGLISH

EXTENDING THE LADDER (FULL WORKING HEIGHT)

Place the ladder on a sturdy level surface on which to use a ladder. Release the strap that secures the ladder in its "storage configuration." Extend the telescopic stabiliser from one side of the ladder. Ensure the stabiliser is fully extended by confirming you can visually see the green indicator. Repeat with the other side. Place your foot on the bottom rung to hold the ladder in place. With both hands start to pull up on the top rung. Extend each section until the steel locking pin engages. You will hear an audible click and see a green indicator on the rung below confirming that section is fully extended and locked. Continue extending the ladder all the way up until you have extended each section. Each rung should show a green lock indicator. Visually inspect the ladder for any damage, debris and that all open sections are locked.



CLOSING THE LADDER

Great care should be used when retracting the ladder. Do not place any part of your body including hands, fingers or thumbs, on, or between rungs or couplings above the closing rung. Ensure that you are on a sturdy level surface. Hold the ladder upright. Place thumbs on the release mechanism located on the second to bottom rung from the ground. Push each release mechanism inward one at a time to unlock the ladder while securing the ladder with the other hand. The entire ladder is now completely unlocked (DO NOT CLIMB LADDER AFTER PERFORMING THIS PROCEDURE). Due to our "soft closing" system, the rungs may need slight guidance while retracting. Note: The Xtend+Climb® ladder utilises a "soft close" system that ensures the rungs retract slowly. Attach the strap that secures the ladder around the top rung. Push the stabiliser bar inward to retract each side to its "storage configuration."



Lightning Latch

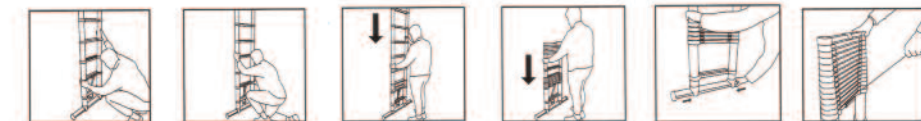

MAINTENANCE TIPS

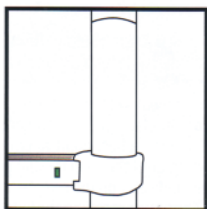

WET LADDER

If the ladder is wet or if there is water on the ladder, open the ladder to the maximum and, with a dry cloth, absorb the water. It is recommended to let the ladder dry fully opened, on one side and then on the other, with the ladder leaning against a wall.



DRY



LET DRY

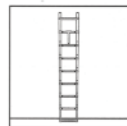

TURN

ENGLISH

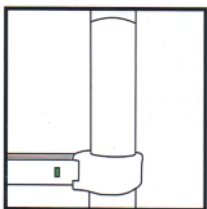

OXIDISED LADDER

If the ladder is oxidised (due to previous poor drying), there will be white residue on the stiles. First, remove the spots with a dry cloth. Then, to ensure the ladder deploys and retracts correctly, use a silicone based spray or a non-petroleum based furniture polish wipe once the ladder is fully opened and dry it correctly. Wait a few minutes and close the ladder. Never use a petroleum based product – it will damage the internal mechanism of your ladder.



CLEAN

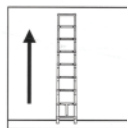

EXTEND



MAINTAIN



PETROLEUM

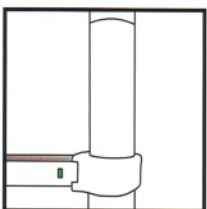

PAINT OR OTHER SUBSTANCES STICKING TO STILES

If paint residues were left on the ladder, they must be removed using a sponge. Do not use steel wool since it might damage the opening/closing mechanism. After all residues have been removed from the stiles, apply a silicone based spray or a non-petroleum based furniture polish wipe as indicated in above section "Oxidised Ladder".



CLEAN



MAINTAIN



STEEL WOOL

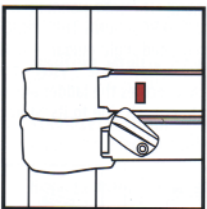

HARD TO MOVE LATCHES

If the latches are hard to push, use a compressor or compressed air duster to properly clean the latches. Then perform maintenance on the latches (with a silicone based spray or a non-petroleum based furniture polish wipe) with a forward/backward movement. Dry excess spray with a dry cloth.

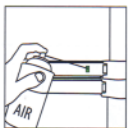

CLEAN

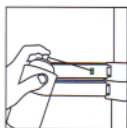

MAINTAIN



DRY

MAINTENANCE TIPS

(CONTINUATION)

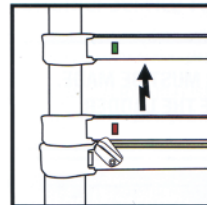

DIFFICULTY IN OPENING OR CLOSING THE LADDER

If it becomes hard to open or close the ladder fully, extend the ladder, clean it, and maintain the stiles with a silicone based spray or a non-petroleum based furniture polish wipe. If the rungs are jammed, use the spray on every stile and close the ladder for 15 to 20 minutes to let the lubricant penetrate the ladder. Then, open and close the ladder to ensure the spray reaches every area of the ladder.

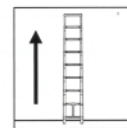

EXTEND



CLEAN



MAINTAIN

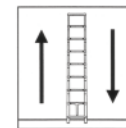

OPEN & CLOSE

ENGLISH

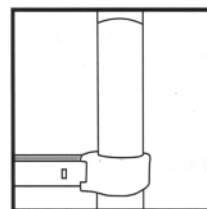

WINTER CONDITIONS

If the opening/closing of the ladder is affected by winter conditions, open the ladder in a dry area until the stiles reach room temperature i.e. 18 to 21°C. Ensure there is no humidity left on the stiles and couplings. (If there is humidity or oxidation, please refer to section "Wet Ladder" or "Oxidised Ladder"). Finally, with the ladder opened, lubricate all the stiles.

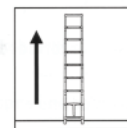

EXTEND

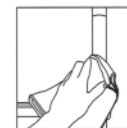

DRY



MAINTAIN

LADDER STORAGE

- Store ladder away from areas where its condition could deteriorate more rapidly (e.g. dampness, excessive heat, or exposure to the elements).
- Store ladder in a position which helps it to remain straight (e.g. hung by the stiles on proper ladder brackets or laid on a flat, clutter free surface).
- Store ladder where it cannot be damaged by vehicles, heavy objects, or contaminants.
- Store ladder where it cannot cause a trip hazard or an obstruction.
- Store ladder securely where it cannot be easily used for criminal purposes.
- If the ladder is permanently positioned (e.g. on scaffolding), secure against unauthorised climbing (e.g. by children).
- Ladders made of or using thermoplastic, thermosetting plastic and reinforced plastic materials should be stored out of direct sunlight.